

(令和元年度)

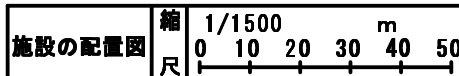

学校名 県立添上高等学校

調査番号 29 (都道府県)(市町村) (学校) 5514

整理番号 617

凡例

建築物

- (未) 未とりこわし建物
- (危) 危険建物
- (借) 借用建物
- (一時) 一時使用建物
- (屋外) 屋外教育環境整備事業によるもの

建物以外の工作物

- 自 自転車置場
- 倉 倉庫
- 吹 吹き抜けの渡り廊下
- 温 温室
- 換 相換場
- 国 国旗掲揚台
- フェンス
- 焼 焼却炉
- 消 消火水槽
- 受 受水槽
- キ キュービクル
- ブ プロパン庫
- 油 油庫
- テ 鉄棒
- 防 防犯灯
- 筒 簡易な小規模構造物
- バ バックネット

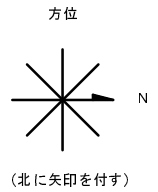
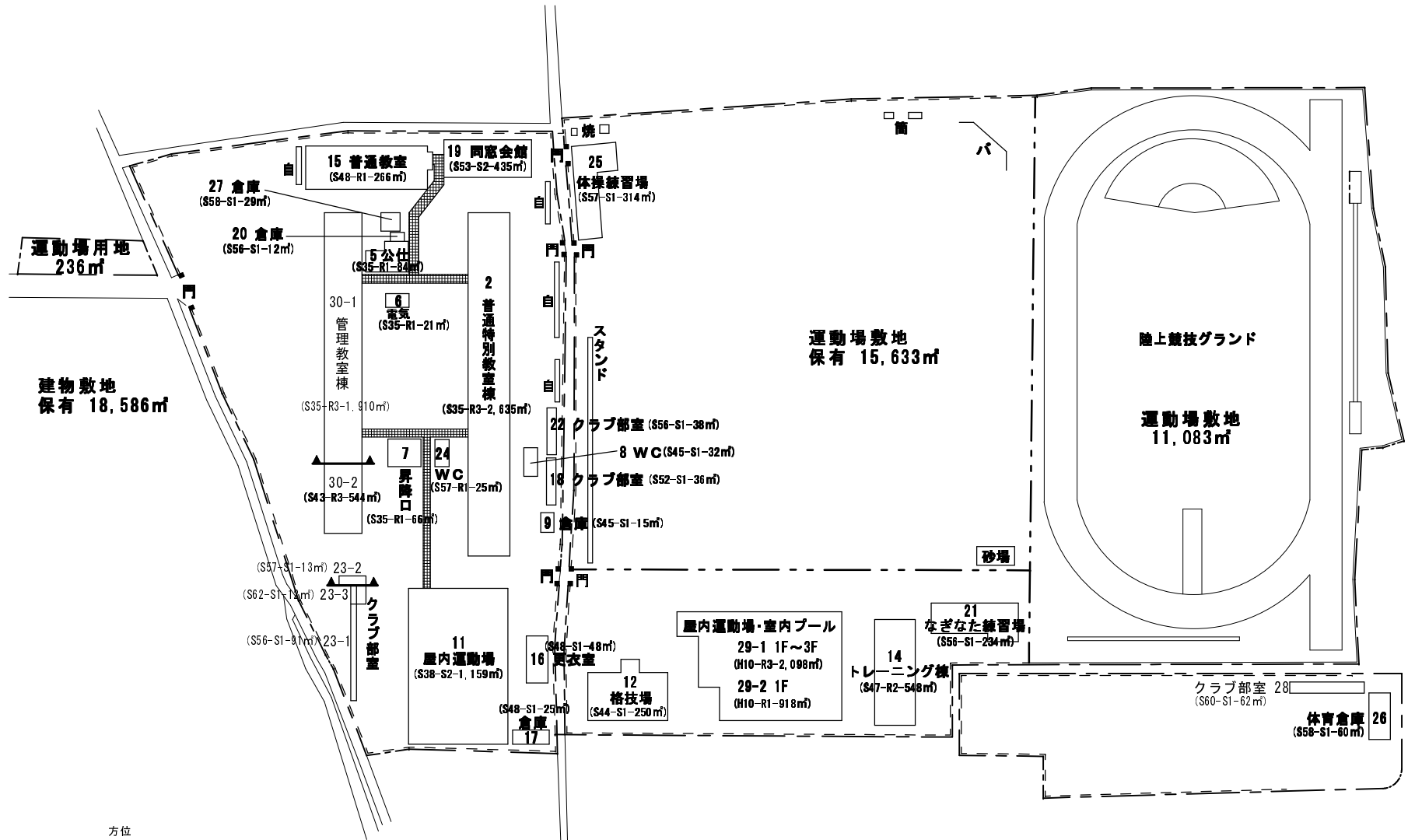

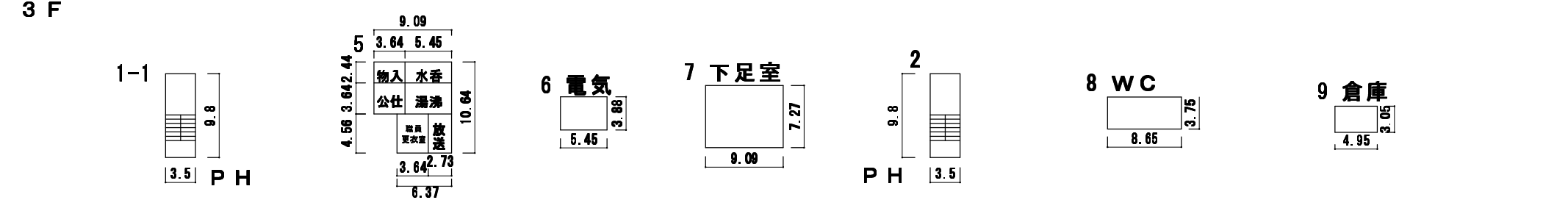
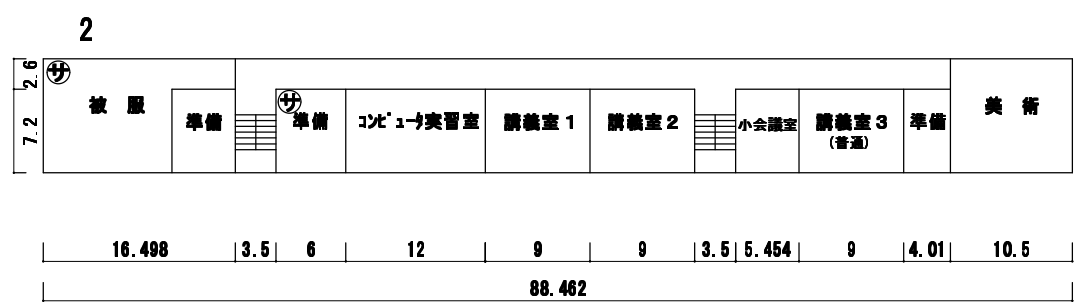
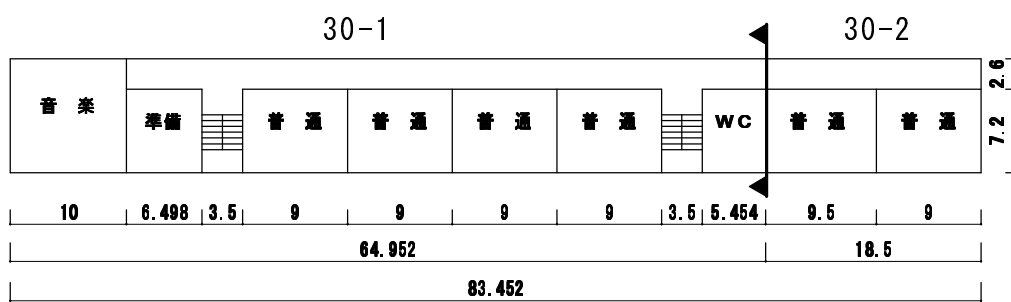
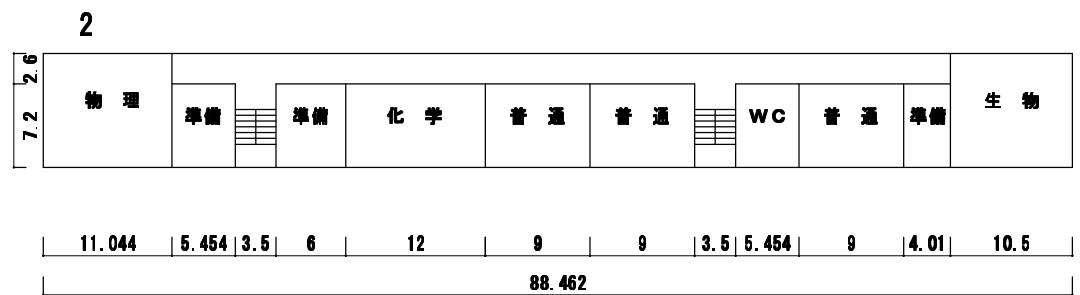
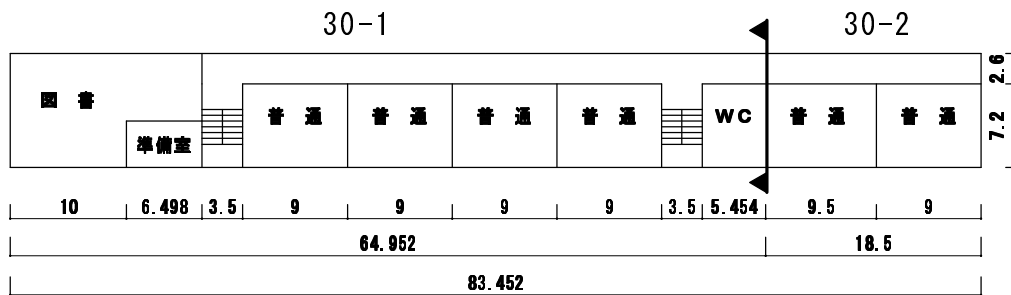
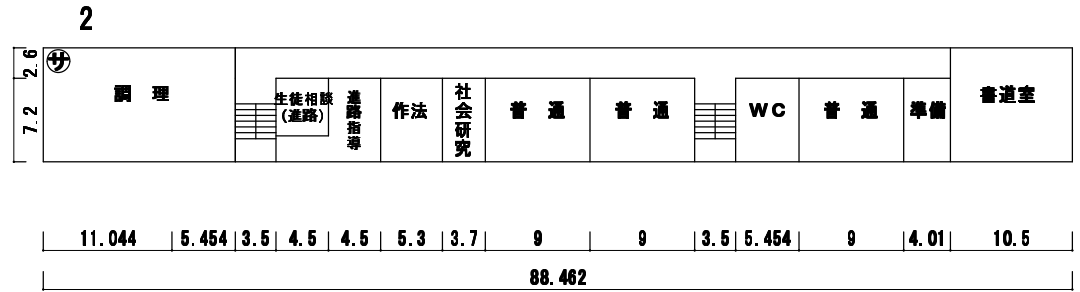
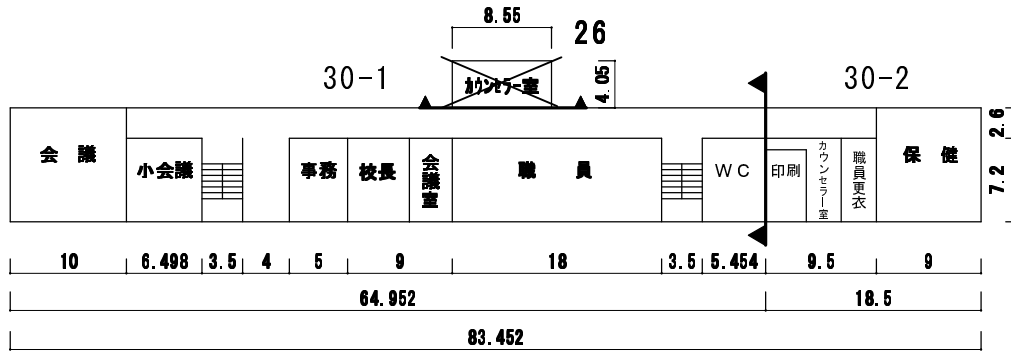

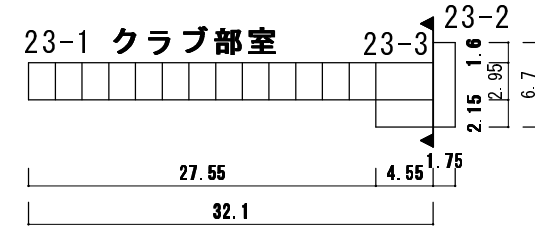
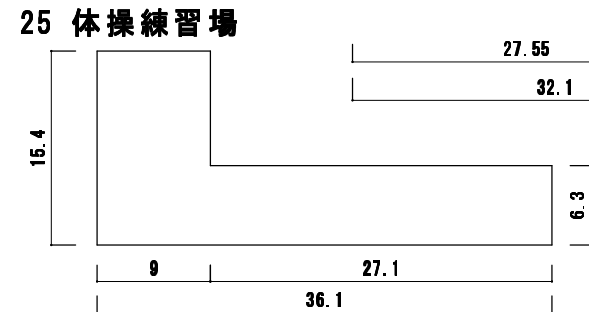
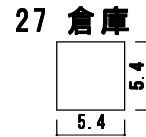
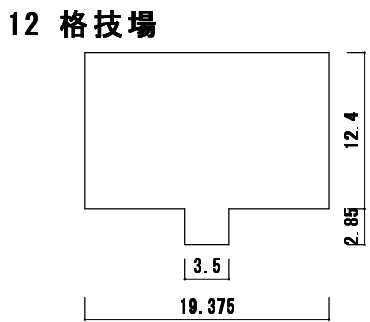
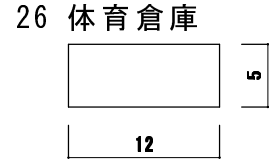
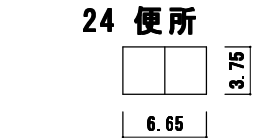
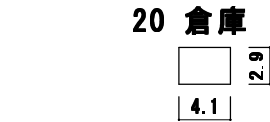
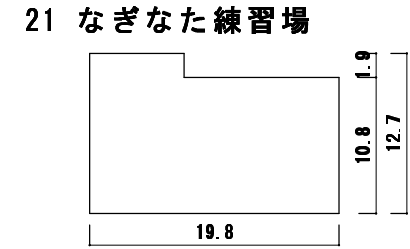
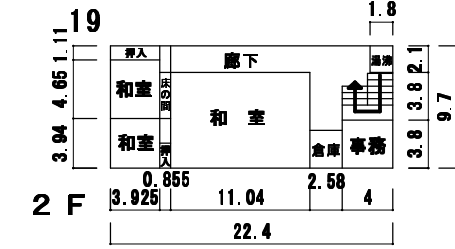
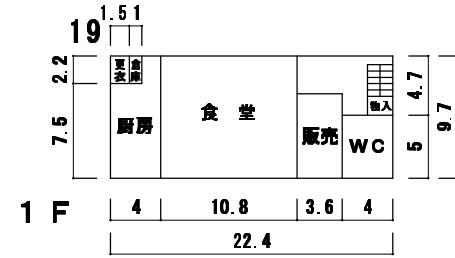
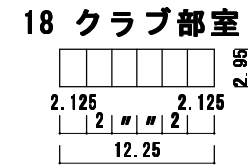
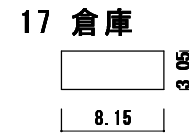
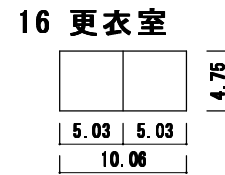
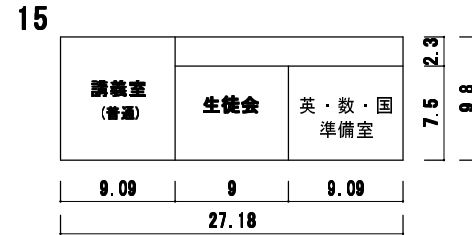
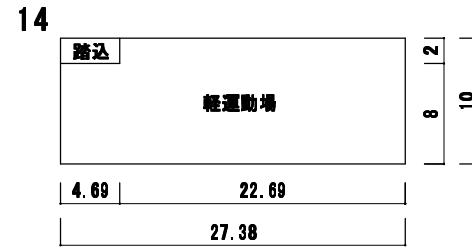
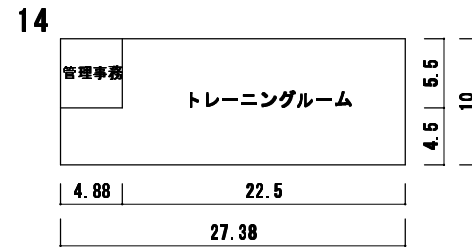
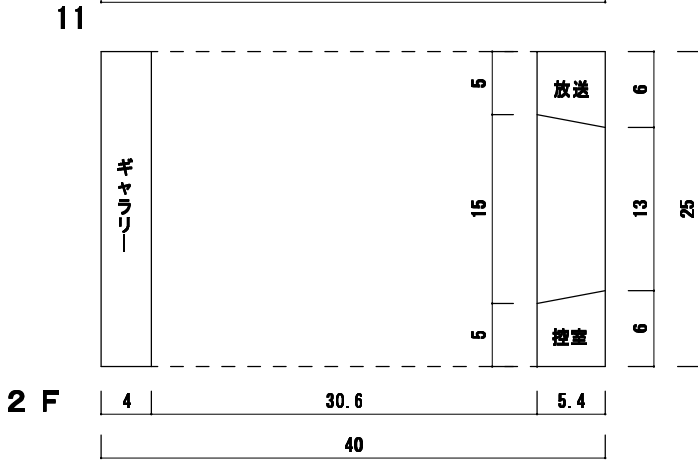
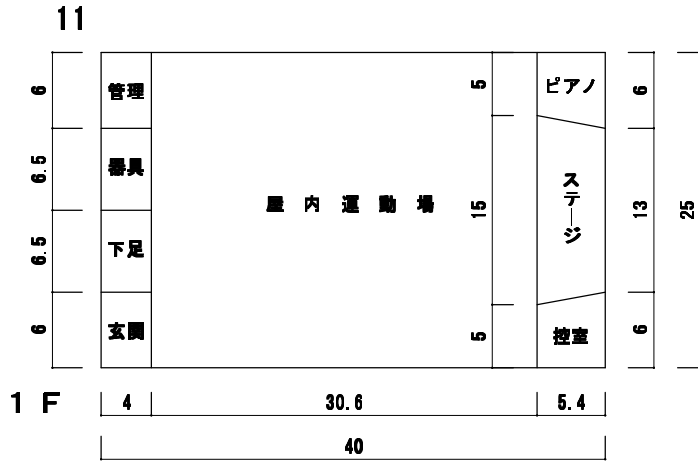

12 格技場	250㎡
18 クラブ部室	36㎡
19 食堂	144㎡
22 クラブ部室	38㎡
23-1 クラブ部室	91㎡
28 クラブ部室	62㎡

(令和元年度)

平面図	縮尺	1/600	0	10	20	30	単位: 米	学校名
-----	----	-------	---	----	----	----	-------	-----

調査番号	(都道府県)	(市町村)	(学校)	整理番号
29			5514	4

29-1

29-2

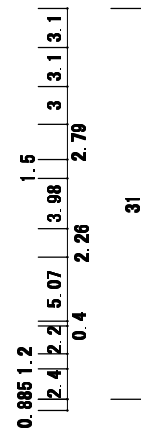
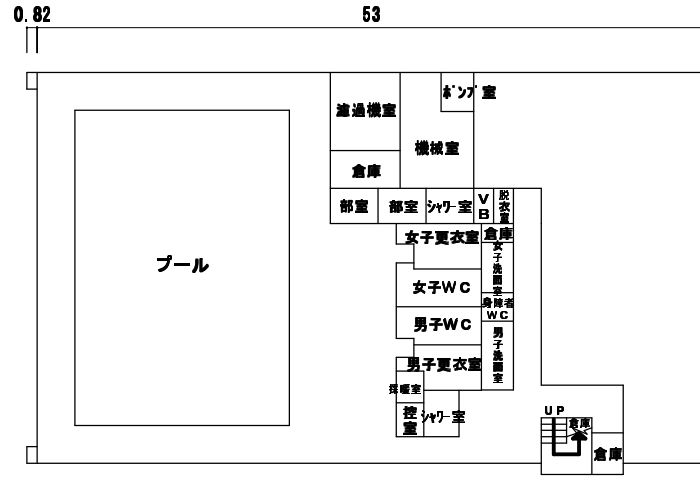
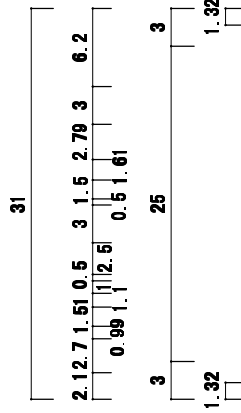

1 F

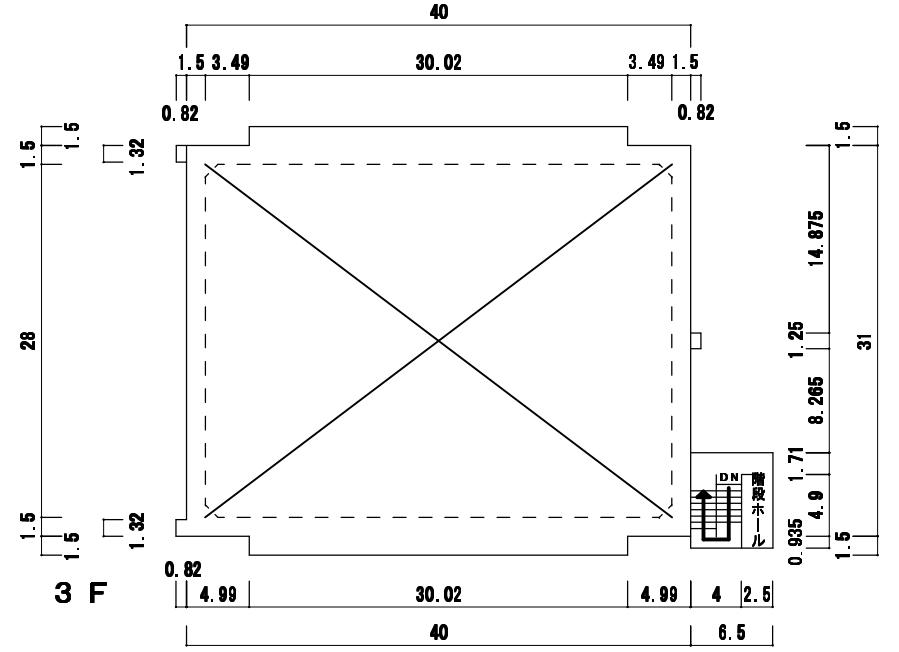
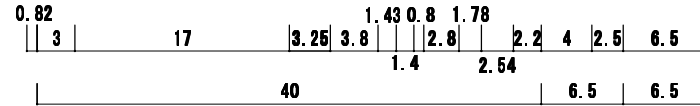

3 F

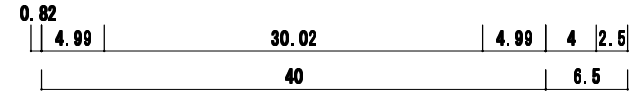

2 F

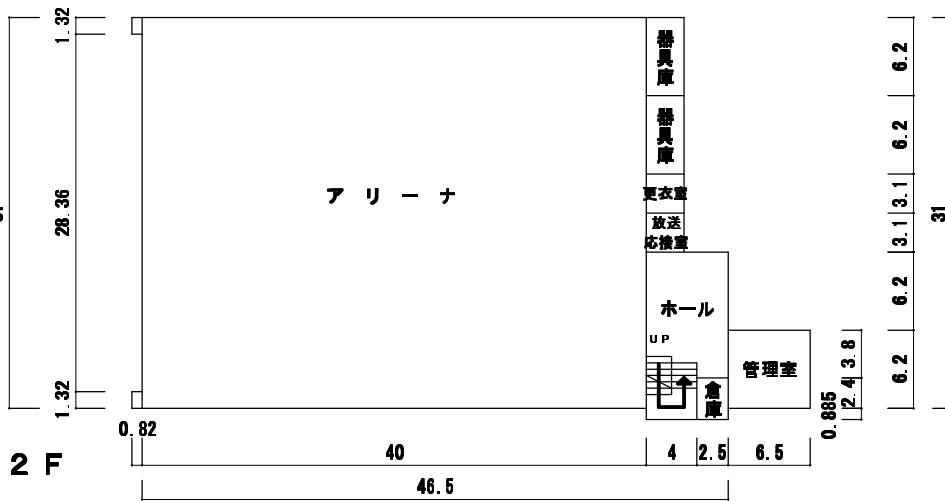

2 F

